

RECEIVED

16 FEB 2012

PUBLIC PROTECTION

Wiltshire Council
Application to vary a premises licence
Licensing Act 2003

For help contact
publicprotectionnorth@wiltshire.gov.uk
Telephone: 0300 456 0100

* required information

Section 1 of 20

You can save the form at any time and resume it later. You do not need to be logged in when you resume.

System reference This is the unique reference for this application generated by the system.

Your reference You can put what you want here to help you track applications if you make lots of them. It is passed to the authority.

Are you an agent acting on behalf of the applicant?

Yes No

Put "no" if you are applying on your own behalf or on behalf of a business you own or work for.

Applicant Details

* First name

* Family name

* E-mail

Main telephone number

Include country code.

Other telephone number

Indicate here if the applicant would prefer not to be contacted by telephone

Is the applicant:

Applying as a business or organisation, including as a sole trader
 Applying as an individual

A sole trader is a business owned by one person without any special legal structure. Applying as an individual means the applicant is applying so the applicant can be employed, or for some other personal reason, such as following a hobby.

Applicant Business

* Is the applicant's business registered in the UK with Companies House? Yes No

* Registration number

* Business name

If the applicant's business is registered, use its registered name.

* VAT number

Put "none" if the applicant is not registered for VAT.

* Legal status

Continued from previous page...

* Applicant's position in the business

Home country

The country where the applicant's headquarters are.

Registered Address

Address registered with Companies House.

* Building number or name

* Street

District

* City or town

County or administrative area

* Postcode

* Country

Agent Details

* First name

* Family name

* E-mail

Main telephone number

Include country code.

Other telephone number

Indicate here if you would prefer not to be contacted by telephone

Are you:

- An agent that is a business or organisation, including a sole trader
- A private individual acting as an agent

A sole trader is a business owned by one person without any special legal structure.

Agent Business

* Is your business registered in the UK with Companies House? Yes No

* Registration number

* Business name

If your business is registered, use its registered name.

* VAT number

Put "none" if you are not registered for VAT.

* Legal status

Continued from previous page...

* Your position in the business

Home country

The country where the headquarters of your business is located.

Agent Registered Address

Address registered with Companies House.

* Building number or name

* Street

District

* City or town

County or administrative area

* Postcode

* Country

The information given here will be saved and will be pre-filled in future forms.

Section 2 of 20

APPLICATION DETAILS

I/we, as named in section 1, being the premises licence holder, apply to vary a premises licence under section 34 of the Licensing Act 2003 for the premises described in section 2 below.

* Premises Licence Number

Are you able to provide a postal address, OS map reference or description of the premises?

Address OS map reference Description

Postal Address Of Premises

Building number or name

Street

District

City or town

County or administrative area

Postcode

Country

Premises Contact Details

Telephone number

Non-domestic rateable value of premises (£)

Continued from previous page...

Section 3 of 20

VARIATION

Do you want the proposed variation to have effect as soon as possible? Yes No

If your proposed variation would mean that 5,000 or more people are expected to attend the premises at any one time, state the number expected to attend

Describe briefly the nature of the proposed variation

TO EXTEND THE SALE OF ALCOHOL HOURS TO 24 HOURS PER DAY, SEVEN DAYS PER WEEK THROUGHOUT THE YEAR. TO ADD THE PROVISION OF LATE NIGHT REFRESHMENT 23.00-05.00 HOURS, SEVEN DAYS PER WEEK, THROUGHOUT THE YEAR.

Section 4 of 20

PROVISION OF PLAYS

Will the schedule to provide plays be subject to change if this application to vary is successful?

Yes No

Section 5 of 20

PROVISION OF FILMS

Will the schedule to provide films be subject to change if this application to vary is successful?

Yes No

Section 6 of 20

PROVISION OF INDOOR SPORTING EVENTS

Will the schedule to provide indoor sporting events be subject to change if this application to vary is successful?

Yes No

Section 7 of 20

PROVISION OF BOXING OR WRESTLING ENTERTAINMENTS

Will the schedule to provide boxing or wrestling entertainments be subject to change if this application to vary is successful?

Yes No

Section 8 of 20

PROVISION OF LIVE MUSIC

Continued from previous page...

Will the schedule to provide live music be subject to change if this application to vary is successful?

Yes No

Section 9 of 20

PROVISION OF RECORDED MUSIC

Will the schedule to provide recorded music be subject to change if this application to vary is successful?

Yes No

Section 10 of 20

PROVISION OF PERFORMANCES OF DANCE

Will the schedule to provide performances of dance be subject to change if this application to vary is successful?

Yes No

Section 11 of 20

PROVISION OF ANYTHING OF A SIMILAR DESCRIPTION TO LIVE MUSIC, RECORDED MUSIC OR PERFORMANCES OF DANCE

Will the schedule to provide anything similar to live music, recorded music or performances of dance be subject to change if this application to vary is successful?

Yes No

Section 12 of 20

PROVISION OF FACILITIES FOR MAKING MUSIC

Will the schedule to provide facilities for making music be subject to change if this application to vary is successful?

Yes No

Section 13 of 20

PROVISION OF FACILITIES FOR DANCING

Will the schedule to provide facilities for dancing be subject to change if this application to vary is successful?

Yes No

Section 14 of 20

PROVISION OF FACILITIES FOR ENTERTAINMENT OF A SIMILAR DESCRIPTION TO THOSE PROVIDED FOR MAKING MUSIC OR DANCING

Will the schedule to provide facilities similar in nature to those provided for making music or dancing be subject to change if this application to vary is successful?

Yes No

Continued from previous page...

Section 15 of 20

PROVISION OF LATE NIGHT REFRESHMENT

Will the schedule to provide late night refreshment be subject to change if this application to vary is successful?

- Yes No

Standard Days And Timings

MONDAY

Start 23:00

End 05:00

Start

End

Provide timings in 24 hour clock (e.g., 16:00) and only give details for the days of the week when you intend the premises to be used for the activity.

TUESDAY

Start 23:00

End ~~23:00~~ 05:00 *fel*

Start

End

WEDNESDAY

Start 23:00

End 05:00

Start

End

THURSDAY

Start 23:00

End 05:00

Start

End

FRIDAY

Start 23:00

End 05:00

Start

End

SATURDAY

Start 23:00

End 05:00

Start

End

SUNDAY

Start 23:00

End 05:00

Start

End

Will the provision of late night refreshment take place indoors or outdoors or both?

- Indoors Outdoors Both

Where taking place in a building or other structure select as appropriate. Indoors may include a tent.

State type of activity to be authorised, if not already stated, and give relevant further details, for example (but not exclusively) whether or not music will be amplified or unamplified.

PROVISION OF HOT DRINKS, SOUPS, PIES & PASTRIES ETC .

Continued from previous page...

State any seasonal variations.

For example (but not exclusively) where the activity will occur on additional days during the summer months.

Non standard timings. Where the premises will be used for the provision of late night refreshment at different times from those listed above, list below.

For example (but not exclusively), where you wish the activity to go on longer on a particular day e.g. Christmas Eve.

Section 16 of 20

SUPPLY OF ALCOHOL

Will the schedule to supply alcohol be subject to change if this application to vary is successful?

Yes No

Standard Days And Timings

MONDAY

Start

End

Start

End

Provide timings in 24 hour clock (e.g., 16:00) and only give details for the days of the week when you intend the premises to be used for the activity.

TUESDAY

Start

End

Start

End

WEDNESDAY

Start

End

Start

End

THURSDAY

Start

End

Start

End

FRIDAY

Start

End

Start

End

Continued from previous page...

SATURDAY

Start

End

Start

End

SUNDAY

Start

End

Start

End

Will the sale of alcohol be for consumption?

- On the premises Off the premises Both

If the sale of alcohol is for consumption on the premises select on, if the sale of alcohol is for consumption away from the premises select off. If the sale of alcohol is for consumption on the premises and away from the premises select both.

State any seasonal variations.

For example (but not exclusively) where the activity will occur on additional days during the summer months.

Non-standard timings. Where the premises will be used for the supply of alcohol at different times from those listed above, list below.

For example (but not exclusively), where you wish the activity to go on longer on a particular day e.g. Christmas Eve.

Section 17 of 20

ADULT ENTERTAINMENT

Highlight any adult entertainment or services, activities, or other entertainment or matters ancillary to the use of the premises that may give rise to concern in respect of children.

Provide information about anything intended to occur at the premises or ancillary to the use of the premises which may give rise to concern in respect of children, regardless of whether you intend children to have access to the premises, for example (but not exclusively) nudity or semi-nudity, films for restricted age groups etc gambling machines etc.

NONE

Section 18 of 20

HOURS PREMISES ARE OPEN TO THE MEMBERS AND GUESTS

Standard Days And Timings

Continued from previous page...

MONDAY

Start

End

Start

End

Provide timings in 24 hour clock (e.g., 16:00) and only give details for the days of the week when you intend the premises to be used for the activity.

TUESDAY

Start

End

Start

End

WEDNESDAY

Start

End

Start

End

THURSDAY

Start

End

Start

End

FRIDAY

Start

End

Start

End

SATURDAY

Start

End

Start

End

SUNDAY

Start

End

Start

End

State any seasonal variations.

For example (but not exclusively) where the activity will occur on additional days during the summer months.

Non standard timings. Where you intend to use the premises to be open to the members and guests at different times from those listed above, list below.

For example (but not exclusively), where you wish the activity to go on longer on a particular day e.g. Christmas Eve.

Continued from previous page...

Identify those conditions currently imposed on the licence which you believe could be removed as a consequence of the proposed variation you are seeking.

CURRENT RESTRICTIONS IN HOURS FOR THE SALE OF ALCOHOL FOR CONSUMPTION OFF THE PREMISES TO BE REMOVED.

- I have enclosed the premises licence
- I have enclosed the relevant part of the premises licence

Reasons why I have failed to enclose the premises licence or relevant part of premises licence.

A COPY OF THE PREMISES LICENCE IS ATTACHED TO THE APPLICATION, THE ORIGINAL IS HELD AT SITE AND CAN BE RETURNED IF REQUIRED.

Section 19 of 20

LICENSING OBJECTIVES

Describe the steps you intend to take to promote the four licensing objectives:

a) General – all four licensing objectives (b,c,d,e)

If the club wishes members and their guests to be able to consume alcohol on the premises select on, if the club wishes people to be able to purchase alcohol to consume away from the premises select off. If the club wishes people to be able to do both select both.

PLEASE SEE ATTACHED SHEET.

b) The prevention of crime and disorder

PLEASE SEE ATTACHED SHEET.

c) Public safety

PLEASE SEE ATTACHED SHEET.

d) The prevention of public nuisance

PLEASE SEE ATTACHED SHEET.

e) The protection of children from harm

Continued from previous page...

PLEASE SEE ATTACHED SHEET.

Section 20 of 20

PAYMENT DETAILS

This fee must be paid to the authority. If you complete the application online, you must pay it by debit or credit card. Variation Fees are determined by the non domestic rateable value of the premises.

To find out a premises non domestic rateable value go to the Valuation Office Agency site at http://www.voa.gov.uk/business_rates/index.htm

Band A - No Rateable Value up to £4300 = £100.00

Band B - £4301 up to £33000 = £190.00

Band C - £33001 up to £8700 = £315.00

Band D - £87001 up to £12500 = £450.00*

Band E - £125001 and over = £635.00*

There are additional fees for Premises Licence Application with numbers of persons present at any one time over 5,000.

Capacity 5000-9999	£1,000.00
Capacity 10000 -14999	£2,000.00
Capacity 15000-19999	£4,000.00
Capacity 20000-29999	£8,000.00
Capacity 30000-39000	£16,000.00
Capacity 40000-49999	£24,000.00
Capacity 50000-59999	£32,000.00
Capacity 60000-69999	£40,000.00
Capacity 70000-79999	£48,000.00
Capacity 80000-89999	£56,000.00
Capacity 90000 and over	£64,000.00

* Fee amount (£)

315.00

Continued from previous page...

ATTACHMENTS

- Copy of Premises Licence
- Plan of Premises
- Consent Form of Designated Premises Supervisor

AUTHORITY POSTAL ADDRESS

Address

Building number or name

Street

District

City or town

County or administrative area

Postcode

Country

DECLARATION

* I/we understand it is an offence, liable on conviction to a fine up to level 5 on the standard scale, under section 158 of the licensing act 2003, to make a false statement in or in connection with this application.

Ticking this box indicates you have read and understood the above declaration

This section should be completed by the applicant, unless you answered "Yes" to the question "Are you an agent acting on behalf of the applicant?"

* Full name

* Capacity

Date (dd/mm/yyyy)

Page 19.

Section P Describe the steps you intend to take to promote the four licensing objectives:

a) General-all four licensing objectives (b, c, d, e)

A suitable and sufficient CCTV system with recording facilities will be in place at site and will operate at all times the premise is open for licensable activities. Images can be made available upon reasonable request by the Police or other relevant officers of a responsible authority.

Staff will be trained with regard to their responsibilities in the retail sale of alcohol and regular refresher training will also be undertaken. Training records can be made available for inspection upon reasonable request by the Police or other relevant officers of a responsible authority.

A refusals book will be operated and maintained and will be produced to a relevant officer of the Police or other relevant officers of a responsible authority upon request.

A Challenge 25 policy will be operated at the premise, acceptable forms of identification are a passport, photocard driving licence and PASS accredited identification card.

Spirits will be located behind the counter.

b) The prevention of crime and disorder.

A suitable and sufficient CCTV system with recording facilities will be in place at site and will operate at all times the premise is open for licensable activities. Images can be made available upon reasonable request by the Police or other relevant officers of a responsible authority.

Spirits will be located behind the counter.

Staff will be trained with regard to their responsibilities in the retail sale of alcohol and regular refresher training will also be undertaken. Training records can be made available for inspection upon reasonable request by the Police or other relevant officers of a responsible authority.

c) Public Safety.

A suitable and sufficient CCTV system with recording facilities will be in place at site and will operate at all times the premise is open for licensable activities. Images can be made available upon reasonable request by the Police or other relevant officers of a responsible authority.

d) The prevention of crime and disorder.

Staff will be trained with regard to their responsibilities in the retail sale of alcohol and regular refresher training will also be undertaken. Training records can be made available for inspection upon reasonable request by the Police or other relevant officers of a responsible authority.

e) The protection of children from harm.

Staff will be trained with regard to their responsibilities in the retail sale of alcohol and regular refresher training will also be undertaken. Training records can be made available for inspection upon reasonable request by the Police or other relevant officers of a responsible authority.

A refusals book will be operated and maintained and will be produced to a relevant officer of the Police or other relevant officers of a responsible authority upon request.

A Challenge 25 policy will be operated at the premise, acceptable forms of identification are a passport, photocard driving licence and PASS accredited identification card.

Spirits will be located behind the counter.

Pace Show Meadow,
 Swindon Road
 Wootton Bassett
 Wiltshire
 SN4 7HF

Lockett & Co
 Retail, Licensing & Training Consultants

RECEIVED
 16 FEB 2012
 PUBLIC PROTECTION

Drawn by: M. Goldsmith.
 Scale: 1:100
 Date: January 2012

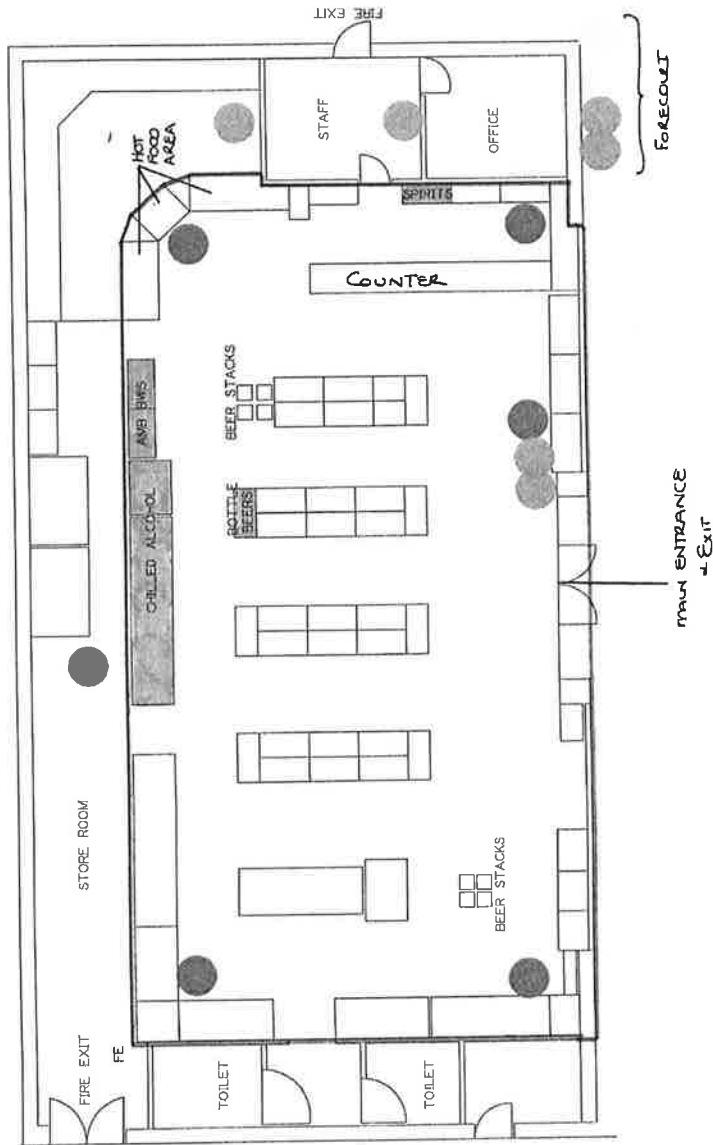

Key:

- Area to be licensed for the sale of alcohol for consumption off the premises and Late Night Refreshment
- CCTV camera.
- Fire extinguisher.
- Fire bucket.

PUBLIC NOTICE OF AN APPLICATION TO VARY A PREMISES LICENCE UNDER SECTION 34 OF THE LICENSING ACT 2003

Notice is hereby given that an application was made to **WILTSHIRE COUNCIL** to vary a premises licence under the above Act on the **17TH FEBRUARY 2012**.

Applicant: **PACE PETROLEUM LIMITED**

Address of premises: **PACE SHOW MEADOW
SWINDON ROAD
WOOTTON BASSETT
WILTSHIRE
SN4 7HF**

RECEIVED
16 FEB 2012
PUBLIC PROTECTION

Proposed variation to the licensable activities:

**TO EXTEND THE HOURS FOR THE SALE OF ALCOHOL FOR CONSUMPTION OFF THE PREMISES
TO ADD THE PROVISION OF LATE NIGHT REFRESHMENT**

Proposed days and hours of licensable activity:

EVERY DAY

ALCOHOL SALES

00.00 TO 24.00

LATE NIGHT REFRESHMENT

23.00 TO 05.00

The postal address of the Licensing Authority where the register is kept and the application may be inspected is:

***WILTSHIRE COUNCIL, MONKTON PARK, CHIPPENHAM, WILTSHIRE, SN15 1ER.**

Any person wishing to make representations on this matter shall give notice, in writing, stating the nature and grounds for making such representations to The Licensing Officer at the above address* within 28 days of the date of this notice – by the **16TH MARCH 2012**.

Further information is available on the web site www.wiltshire.gov.uk following the links.

It is an offence, under section 158 of the Licensing Act 2003, to knowingly or recklessly make a false statement in or in connection with an application and the maximum fine on summary conviction of such an offence is £5000.

Lockett & Co – duly authorised agents

LICENSING ACT 2003

PREMISES LICENCE

PREMISES LICENCE NUMBER: LN/003028 NL

Premises Details

Postal address of premises, or if none, ordnance survey map reference or description	
Esso Spar Show Meadow Swindon Road Wootton Bassett	
Post Town Swindon	Post Code SN4 7HF
Telephone Number 01793 855147	

Licensable activities authorised by the Licence	The time the licence authorises the carrying out of licensable activities
Supply of Alcohol - for consumption off the premises	Alcohol shall not be sold or supplied except during permitted hours.
	Permitted hours means:
	a. On weekdays, other than Christmas Day, 8 am to 11 pm
	b. On Sundays, other than Christmas Day, 10 am to 10.30 pm
	c. On Christmas Day, 12 noon to 3 pm and 7 pm to 10.30 pm
	d. On Good Friday, 8 am to 10.30 pm

Name, (registered) address of holder of Premises Licence	
Pace Petroleum Limited Vincent House 4 Grove Lane Epping Essex	
Post Town Epping	Post Code CM16 4LH
Telephone Number 01793 855147	

Name of Designated Premises Supervisor where the Premises Licence authorises for the supply of alcohol	
Kandasamy Chandrabalu	
Personal Licence Number: LN/003958 NL	Licensing Authority: North Wiltshire District Council

Licence Commencement Date

24th November 2005

.....
Licensing Officer

Current Licence Date

15th February 2010

.....
Licensing Officer

ANNEX 1 - MANDATORY CONDITIONS

Door Supervision

Individuals who are present to guard against a, b or c must be licensed by the Security Industry Authority:

- a. Unauthorised access or occupation (eg through door supervision)
- b. Outbreaks of disorder
- c. Damage

Supply of Alcohol

Where this Licence authorises the supply of alcohol:

No supply of alcohol may be made under this licence:

- a. At a time when there is no Designated Premises Supervisor in respect of it
- b. At a time when the Designated Premises Supervisor does not hold a Personal Licence or his Personal Licence is suspended"

Every retail sale or supply of alcohol made under this licence must be made or authorised by a person who holds a Personal Licence.

Exhibition of Films

Where this Licence authorises the exhibition of films:

The admission of children under the age of 18 to film exhibitions permitted under the terms of this licence shall be restricted in accordance with any recommendations made:

- a. By the British Board of Film Classification (BBFC,) where the film has been classified by that Board
- By the Licensing Authority where no classification certificate has been granted by the BBFC or, where the Licensing Authority has notified the licence holder that section 20 (3) (b) (74 (3) (b) for clubs) of the Licensing Act 2003 applies to the film.

ANNEX 2A - CONVERTED CONDITIONS

- The restrictions relating to the permitted hours for the sale and supply of alcohol do not prohibit:
 - a. The taking of the alcohol from the premises, (unless the alcohol is supplied or taken in an open vessel,) during the first twenty minutes after the above hours
 - b. The ordering of alcohol to be consumed off the premises, or the despatch by the vendor of the alcohol so ordered
 - c. The sale of alcohol to a trader or club for the purposes of the trade or club
 - d. The sale or supply of alcohol to any canteen or mess, being a canteen in which the sale or supply of alcohol is carried out under the authority of the Secretary of State or an authorised mess of members of Her Majesty's naval, military or air forces.
- Alcohol shall not be sold in an open container or be consumed in, the licensed premises.

ANNEX 2B - OPERATING SCHEDULE

PREVENTION PUBLIC NUISANCE

None.

PUBLIC SAFETY

None.

PROTECTION OF CHILDREN FROM HARM

None.

PREVENTION OF CRIME AND DISORDER

None.

ANNEX 3 - HEARING

None.

ANNEX 4 - PLANS

See Attached